

Better Cushion  
Better Protection



# HANDBOOK

Version 2017

02476 420065

[www.kitepackaging.co.uk](http://www.kitepackaging.co.uk)

## Kite Packaging – WEE/FG4261QZ

The WEEE Regulations require the UK to maximise the separate collection, reuse and recycling of WEEE. They apply to all Electronic and Electrical Equipment (EEE) placed on the market in the UK covered by the scope of the Regulations.

Reuse and recycling of WEEE has several environmental benefits including reduction of raw material and energy usage, prevention of landfill and prevention of hazardous/toxic materials contaminating the environment.

Under the UK WEEE Regulations this product should not be discarded in the general waste stream.

There is a network of recycling centres across the UK where consumers of WEEE can take WEEE free of charge to be discarded, reused and/or recycled. The complete list of locations can be found using the “Find your nearest Recycling Locations” option at <https://www.recyclenow.com/local-recycling>.

If you would like to arrange for us to take back this product please contact us on 02476 420065 There will be a transport charge for such WEEE but you will not be charged in relation to the cost of treatment of reprocessing of WEEE as defined by the Regulations.

## Catalogue\_\_

► Safety statement.....	1
► Technical Data.....	2
► Machine Accessories.....	2
► Overview.....	3
► Operation instruction.. ..	4-5
► Data setting.....	6-8

## Caution\_\_

## Safety statement\_\_

Please read safety statement and operating instructions before using the machine.

- 1、Machine should be kept away from water.
- 2、Please locate the machine on a safe flat surface.
- 3、Please turn the power off before cleaning or carrying out any maintenance or repair.
- 4、Be sure not to insert your finger or anything into the machine while the power is connected.
- 5、Do not repair the machine without consulting our technical engineer.

For machine problems, please call the service line

**02476 420065**

## Technical Data\_\_

Power: 110v/220v; 50Hz  
 Rated: 180W  
 Speed: 8M/min~18M/min  
 Weight: 5.8KGS  
 Color: Blue  
 Size: 330 × 310 × 280mm

## Accessories\_\_

You will find them in the machine carton:



Spanner ( 4pcs )



Belt ( 2pcs )



Knife kit ( 1set )



Pin roller ( 1set )

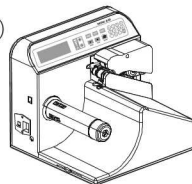

Power cord ( 1pc )

## Overview

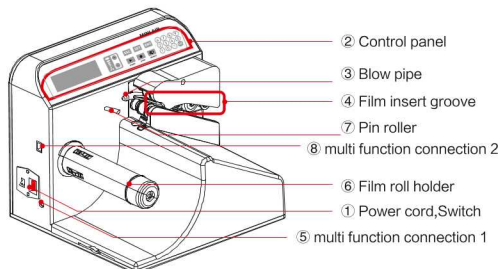

① **Power cord, Switch:** Insert provided power cord into the machine, switch machine power on.

② **Control Panel:** Mini Air control panel, adjust sealing temperature, air volume, film length, start and stop the machine.

③ **Blow pipe:** Insert film roll over the blow pipe for producing air cushions.

④ **Film insert groove:** Pull film through, use IN/OUT on the control panel to feed.

⑤ **multi function connection 1:** connect to use with different function (e.g. foot pedal, sensor, winder).

⑥ **Film roll holder:** Load the film roll onto the film roll holder.

⑦ **Pin roller:** For wrapper film types only.

⑧ **multi function connection 2:** connect to use with different function (e.g. foot pedal, sensor, winder).

## Operation instructions

A. Connect the power cord and switch on, the power light will illuminate. (pic.1)

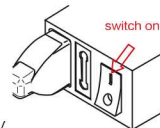

Pic.1

B. Machine will enter main page(pic.2) automatically after 5 seconds. Each function on pic.3 will introduce on data setting.



pic.2



pic.3

C. Loading film roll

a) Air channel is on the green/black line side, make sure you put this side near blow pipe.



pic 4

- b ) Insert the air channel over blow pipe  
(pic4),  
pull the film through the film groove.  
(pic 5)

PS: when using wrapper,the film should be under the pin roller, see pic 6.

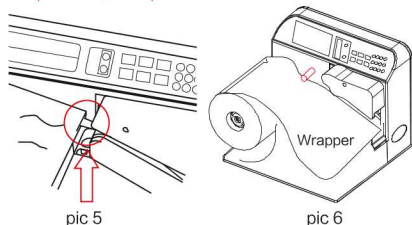

air channel insert into blow pipe

Pic.7,pull the film over the blow pipe and through the film groove,hold on “IN/OUT” button,then pull the film completely through.

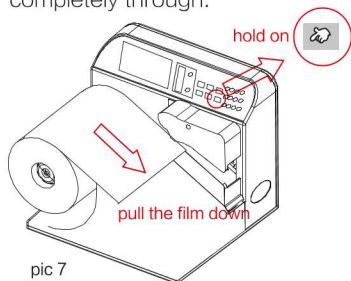

## Data setting

Use control panel to set the required sealing temperature and air volume, as well as to adjust the length of cushions produced.

( Only set data when needed)



pic 8 control panel

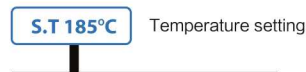

This is the temperature at which the air cushion is heat sealed .The light will illuminate when the machine has reached the pre-set temperature.  
Press “SET” change over to “S.T.” ,  
input data you need.  
Press “ENT” finish setting.



Length setting

Set the length you need, measured in meters.

The offset is 0m, this means continuous running.

e.g. need 50 meters air cushion, input the numbers 50, machine will stop after making 50 meters.



The column displays the current sealing temperature status (like a thermometer), the column will fill as the temperature changes. When the set temperature is reached, the symbol "O" will turn to "●".

PS: If the screen display "waiting" means the temperature is not ready, please wait, the machine will start when the temperature is ready.



Air volume control

Air volume range is 0-40, this can be adjusted in two ways.

- 1、Use control panel "+" and "-" button to adjust (in this way, air volume will back to initial setting when machine is restarted);
- 2、Press "SET" button to input numbers you need (in this way, air volume will stay same when machine is restarted).

## Temperature and air volume reference

Film Typ	S.T	A.V
FILLER	180°C-200°C	24-26
WRAPPER	190°C-220°C	40

Warranty: machine has 12 month warranty  
Warranty does not include the following:

- Teflon belt, knife.
- Using unsuitable film which not sold by Kite.
- Improper use or damage during transportation.

